

Centrifugal Systems
Gennaretti
GETECH S.R.L.
Discover the different separation

S.P.A.C.I. 1 + S.P.A.C.I. 9
TECHNICAL PROPOSAL S.P.A.C.I.

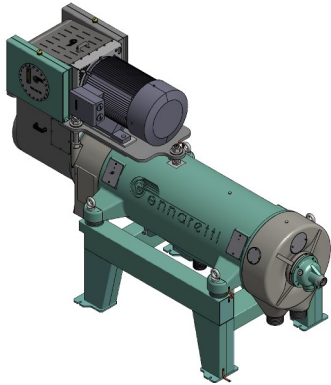

Data Sheet

SPACI 1 + SPACI 9

Rev. 00

All the GETECH plants and centrifuges are designed and manufactured with advanced materials and technologies to make them reliable over the time.
 The design makes them unique, rational, robust and compact.
 The special components layout allows easy maintenance and quick installation.
 The drive with a single electric motor is located in the upper part of centrifuges to minimize footprint area.
 With this solution, you will have the thirty-year experience of the whole Company and its engineers.



100% made in Italy, build, designed and assemble in Italy

Ecology	Treatment for separation solid / liquid
----------------	---

Hydraulic Capacity	60 m ³ /h The effective capacity depends on the product to be treated, its percentage of solid and by the physical characteristics of separability.
Bowl Rotation Speed	Adjustable between 500 and 2500 rpm
Screw Differential Speed	Adjustable from 0,1 to 55 rpm
Maximum Sludge Temperature.	80 °C (*)

(*) optional: up to 150°C

NOTE: It is possible to stack up the 2 container with twist lock solution.

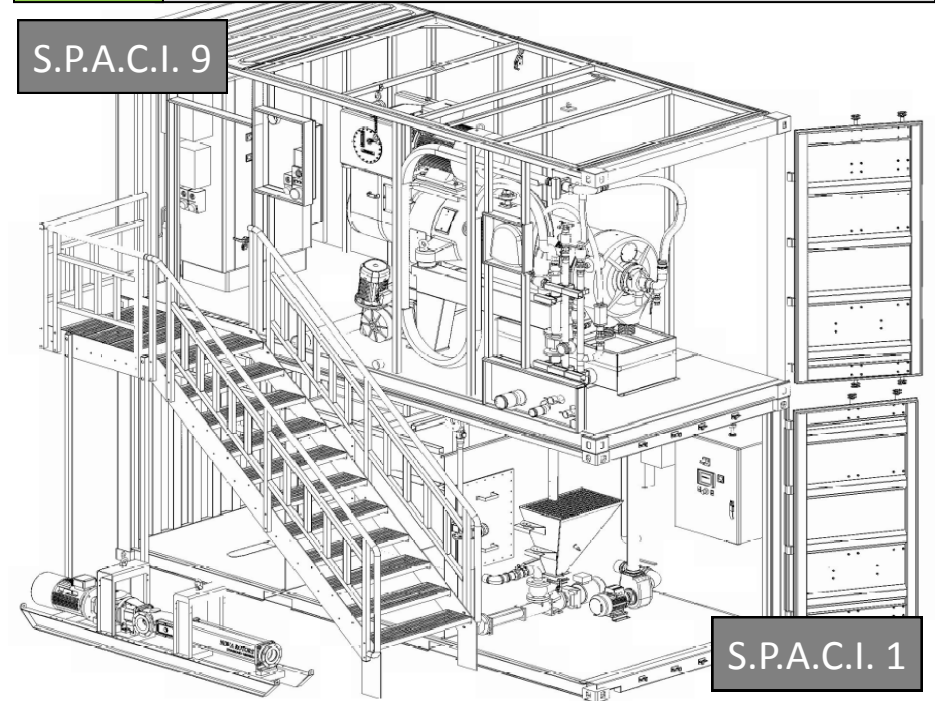

TECHNICAL PROPOSAL

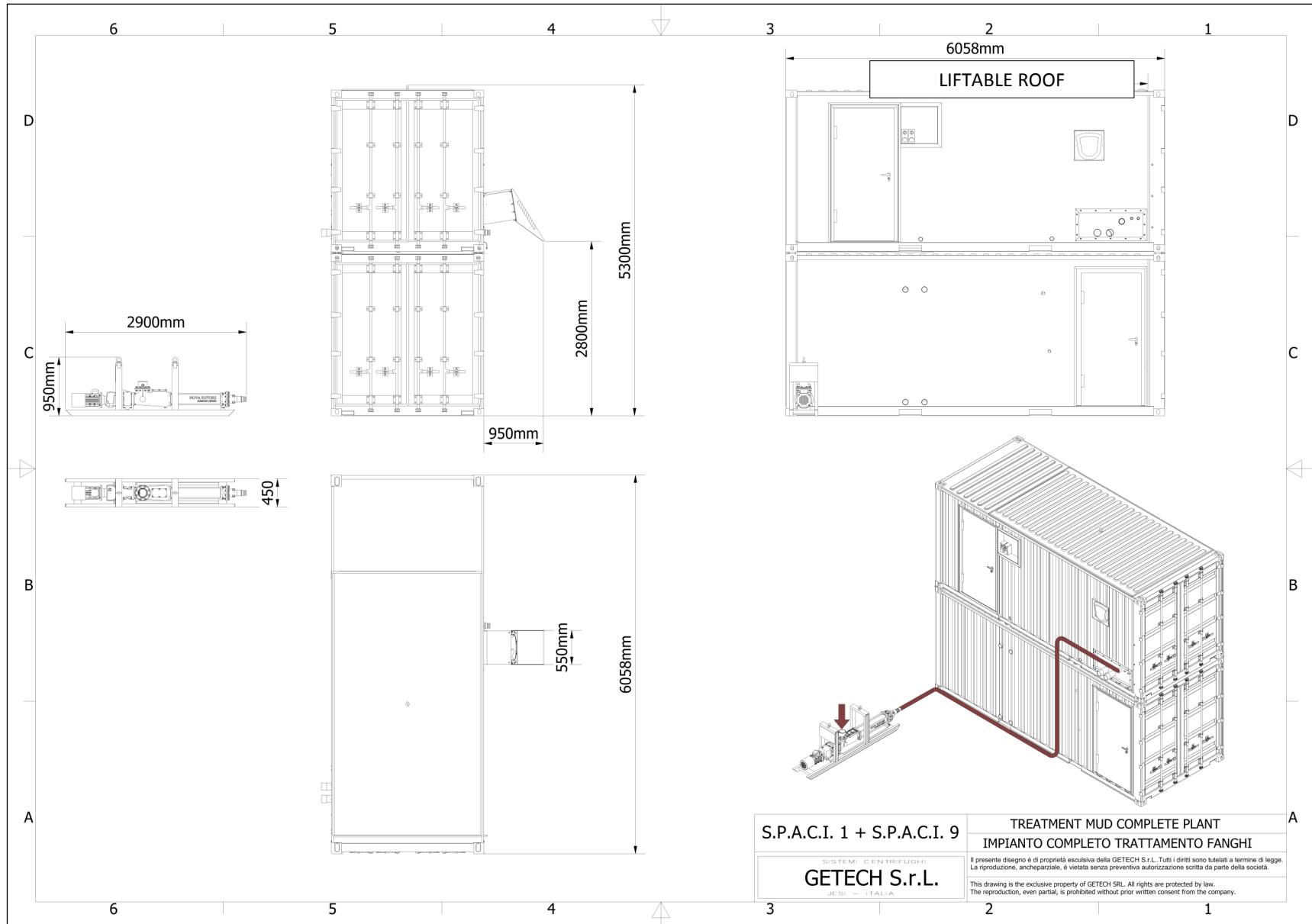

S.P.A.C.I. 1 + S.P.A.C.I. 9

TREATMENT MUD COMPLETE PLANT
 IMPIANTO COMPLETO TRATTAMENTO FANGHI

Il presente disegno è di proprietà esclusiva della GETECH S.r.l. Tutti i diritti sono tutelati a termine di legge. La riproduzione, anche parziale, è vietata senza preventiva autorizzazione scritta da parte della società.

GETECH S.r.l.
SISTEMI CENTRIFUGHI
WEST - ITALIA

This drawing is the exclusive property of GETECH S.r.l. All rights are protected by law. The reproduction, even partial, is prohibited without prior written consent from the company.

03.14.5X20 - SPACI 9 CONTAINER 20'

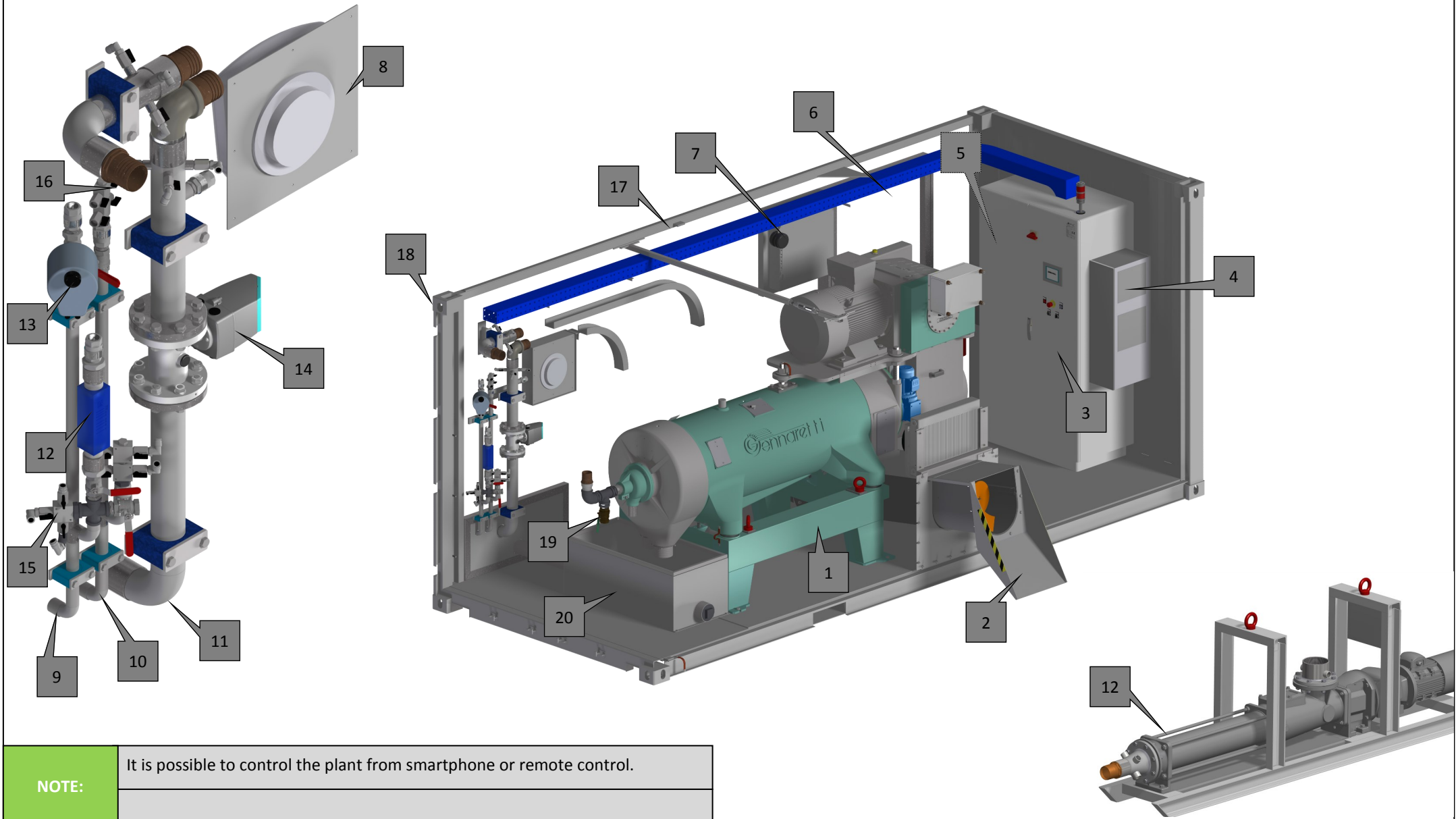

NOTE: It is possible to control the plant from smartphone or remote control.

03.14.5X20 - SPACI 9 CONTAINER 20'

N°=	DESCRIPTION	NOTE	Q.
1	CENTRIFUGE GHT503VF		1
2	SCREW CONVEYOR FOR THE DRY SOLID		1
3	WINDOW		1
4	MAIN ELECRTICAL		1
5	HEATER		1
6	DOOR		1
7	ELECTRICAL POWER		1
8	AERATOR		1
9	FRESH WATER PIPE		1
10	POLYMER READY PIPE		1
11	SLUDGE PIPE		1
12	WATER FLOW-METER DILUTION		1
13	AUTOMATIC VALVE WASHER		1
14	MAGNETIC FLOWMETER WITH DISPLAY FOR SLUDGE		1
15	FIRST INJECTION POINT POLYMER IN THE SLUDGE LINE		1
16	SECOND INJECTION POINT POLYMER IN THE SLUDGE LINE		1
17	ROOF REMOVABLE		1
18	CONTAINER DOUBLE DOORS		2
19	BALL VALVE		1
20	CENTRATE TANK		1

NOTE:

All components are shipping in to the container.

03.14.X2022 - SPACI 1 : AUTOMATIC SYSTEM POLY PREPARATION 8m³+8m³

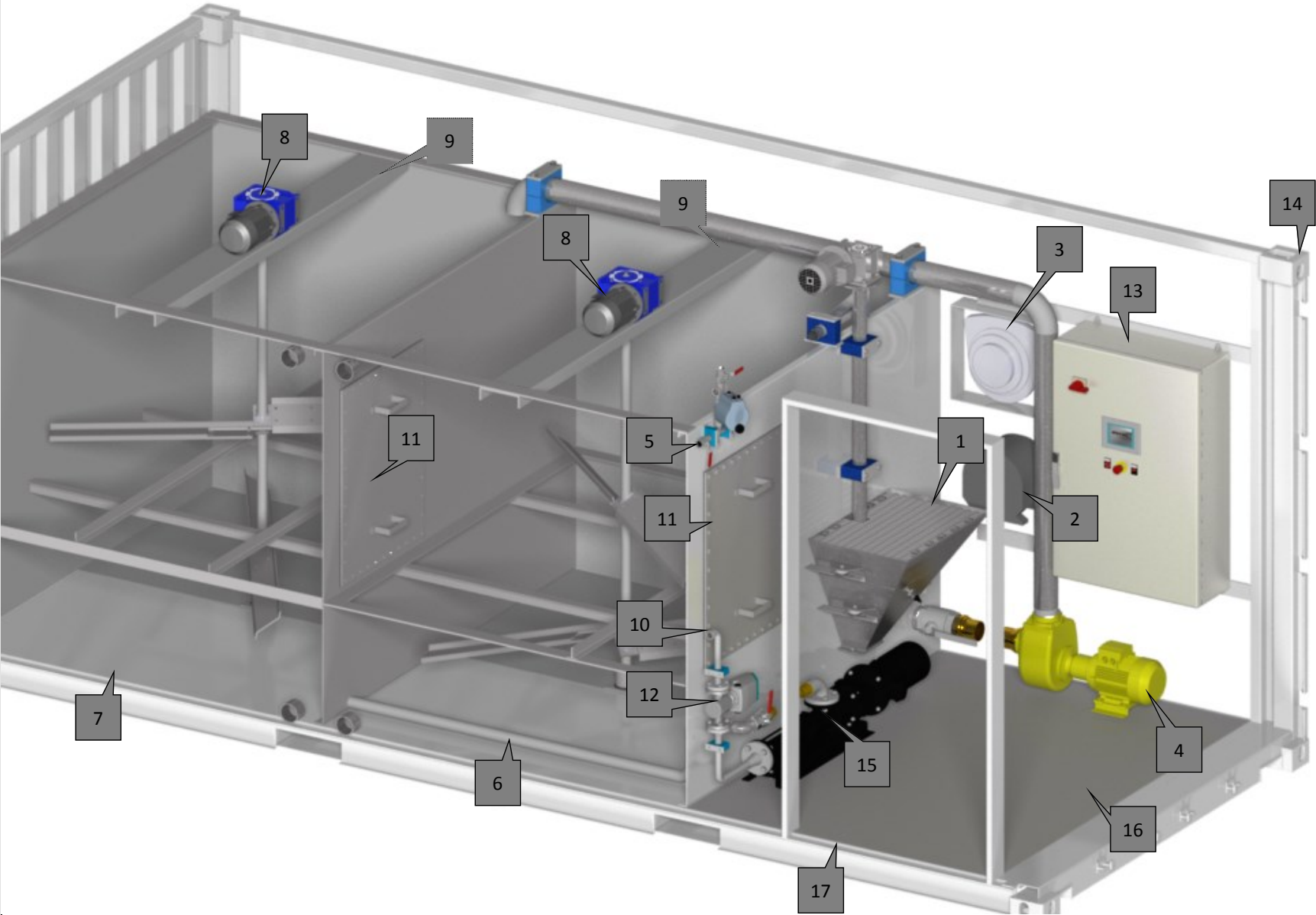

03.14.X2022 - SPACI 1 : AUTOMATIC SYSTEM POLY PREPARATION 16m³

N°=	DESCRIPTION	Q.	NOTE:
1	HOPPER FOR POWDER	1	75 l CAPACITY
2	HEATER	1	
3	AERATOR	1	AERATOR
4	TRANSFER PUMP	1	TRANSFER THE POLYMER READY FROM THE PREPARATION AND AGEING TANK TO THE POLYMER READY STORAGE TANK
5	WATER FRESH CONNECTION	1	FOR THE PREPARATION OF POLYMER MIN. 3 BAR
6	PREPARATION AND AGING POLYMER TANK	1	TANK FOR THE PREPARATION OF THE POLYMER
7	POLYMER READY STORAGE TANK	1	
8	MIXER	2	
9	LEVEL SENSOR	2	NECESSARY FOR THE AUTOMATIC POLYMER PREPARATION
10	CONNECTION FLANGE FOR POLYMER READY	1	
11	INSPECTION PORT	2	
12	MAGNETIC POLYMER FLOWMETER WITH DISPLAY	1	
13	ELECTRICAL CABINET	1	THE TOUCHSCREEN IN THE SPACI 1 CAN BE CONTROL FROM THE MAIN ELECTRICAL CABINET IN THE SPACI 9
14	DOUBLE DOORS OF THE CONTAINER	1	KEEP OUT ~10 m FOR MAINTENANCE
15	POLYMER PUMP	1	FOR INJECTION POLIMER READY IN THE SLUDGE LINE
16	AREA FOR STORAGE OF POLYMER BAG	1	
17	ACCESS DOOR	1	